

RFE860 Nano 120V

Dimensions: 31.5" x 8.7" x 16" LxWxH

Weight: 35 lbs. (approx.)

Media Area: 57 ft²

Filter Cartridges: #70377313

Portable source capture for on-torch extraction

The Fume Eliminator RFE860 is designed to be carried to the working area. Although it can be used with a nozzle, it is specifically developed for on-torch applications - connected directly to the welding torch, it extracts the fume directly at the source. The RFE860 has a knob to set the desired suction level, an automatic start/stop function, which starts the unit as soon as the welding begins and significantly improved motor performance (versus the FE840/841).

The RFE860 is suitable for extraction of fume in maintenance welding applications and is compliant with ISO 21904 (W3).

- Portable and easy to carry.
- Automatically maintains the set extraction flow - ideal for on-torch applications
- Warnings at malfunction and when the filter is 85% and 100% full
- High efficiency Nanofiber filter protecting the user from submicron particles. F9 (EN 779) MERV 14 (ASHRAE 52.2)
- Designed for torches requiring max 18 kPa at connection point - according to ISO 21904

Technical Data

Certifications	CE
Standard	ISO 21904-1
Filter efficiency (%)	99,7
Installation	Indoor
Application	Fumes
Working pressure (kPa)	25
Max Airflow (m3/h)	180
Hose length (m)	2,5
Filter Area (m²)	5,3
Filter type	Cartridge
Number of filter elements	1
Filter material	Cellulose with nanofiber
Weight (lbs.)	35
Hose diameter (mm)	50

Specifications

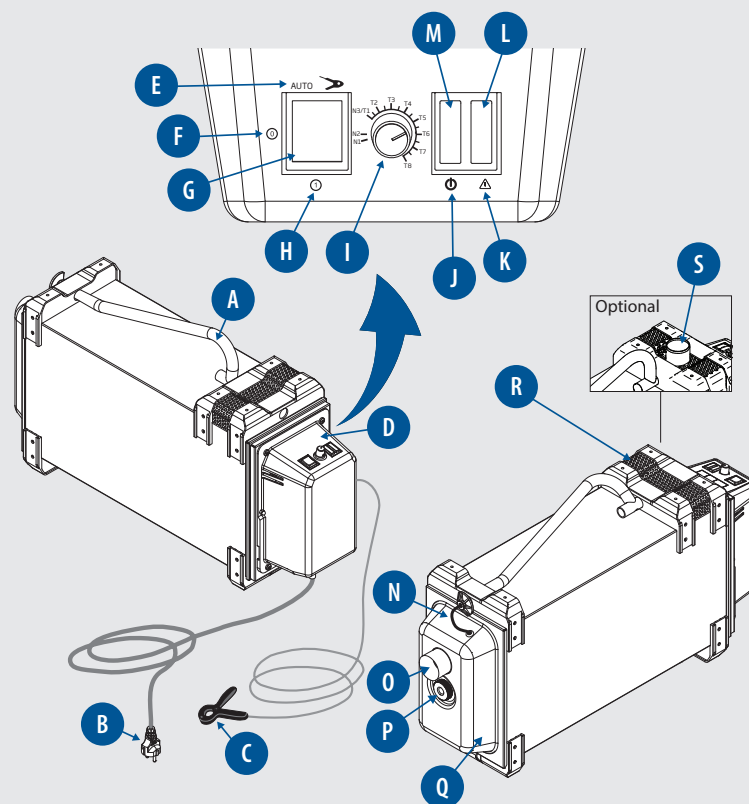

- | | |
|---|--|
| A Handle/lock | J Standby |
| B Plug, electrical connection | K Warning and Alarm |
| C Current sensor clamp for welding or welding return cable | L Orange light |
| D Suction settings, see Table D4.1 | M Green light |
| E Auto position | N Filter indicator hose |
| F Off | O Hose connection |
| G Main switch | P Locking screw |
| H On | Q Coarse separator |
| I Knob for suction power | R Exhaust |
| | S Exhaust, hose connection (optional) |

RFE860 Nano 120V US | ArtNo: 70842040

Power Voltage (V)	120
Frequency (Hz)	60
No of Phases	1
Electric Plug	US
Filter Cleaning Method	One Way Filter
Power (kw)	1.25