

### CFX-4000

**Dimensions:** 60"D x 33"W x 111.25"H

**Base Weight:** 1,073 lbs.

#### Equipment

**Controls:** Manual On / Off Switch

**Voltage Options:** 230 V / 480 V / 575 V

**Heavy Duty Construction:** Fully welded 14 gauge steel

**Filter Design:** Included as standard to improve filter life and reduce energy consumption: Oil Smoke or Oil Mist Option (*See below*)

**Blower / Motor Combination:** Direct drive designed for energy efficiency

**Noise Level:** 85 dBA

**Warranty:** 1 year on cabinet; 1 year on all components ([See warranty document for details](#))

#### Options

**Controls:** VFD Motor Control

**Acoustical Silencer:** Full top plenum (5 dBA reduction)

**Auto Start:** CMR-20

**After Filters:** HEPA (Add 14" to height)

#### Required Selections

Filter (Quantity) & Part #	Filter Description
(2) S1000B750-18	Oil Smoke
(2) S500B375-18	Oil Mist

#### Specifications

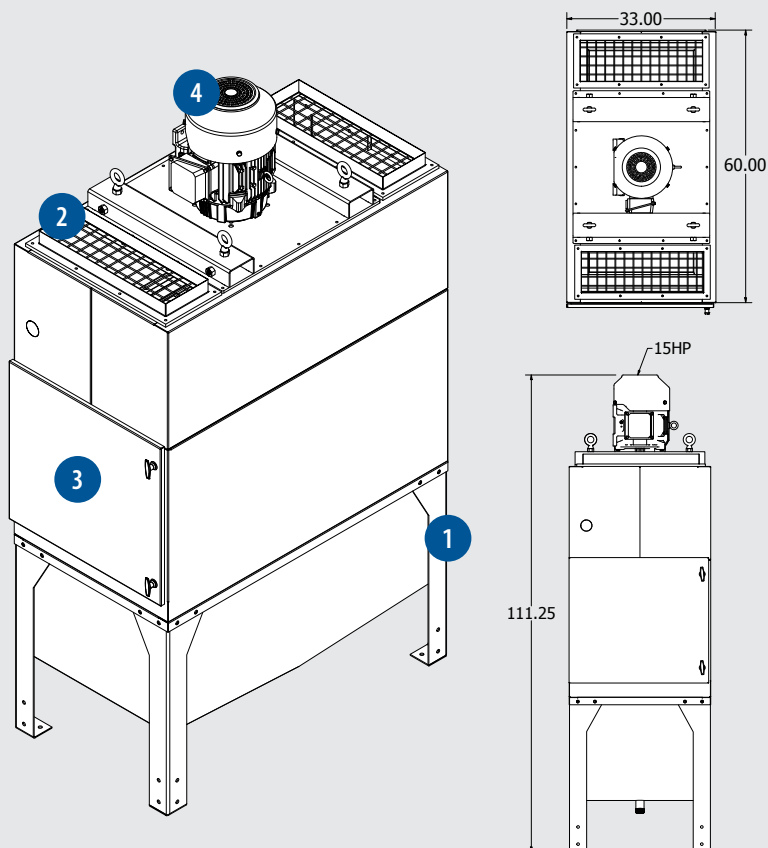

- ① Inlet Area (on back of unit)
- ② Clean Air Exhaust
- ③ Filter Access Door
- ④ Motor

*For exact equipment dimensions, please click submittal drawing below.*

Model No.	Configuration	CFM @ "SP	AMPS @ 480 V
CFX-4000A	7.5 HP • 18 @ 40%	3,000 @ 10.0	11 AMPS
CFX-4000B	15 HP • 20 @ 40%	4,000 @ 10.0	21 AMPS

#### Additional Resources and Downloads (click image to retrieve material)



Owner's Manual



Product Sheet



Website

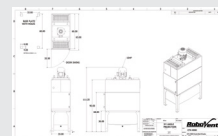

Submittal Drawing